



WEET Technology Company Limited

High Speed Switching Diode

1N4148W

VOLTAGE RANGE 100 Volts
CURRENT 150m Ampere

FEATURES

- Fast switching for high efficiency
- Fast Switching Device (TRR <4.0 nS)
- Power Dissipation of 500mW
- High Stability and High Reliability
- Low leakage
- High temperature soldering guaranteed:
250°C/10 second at terminals

SOD-123

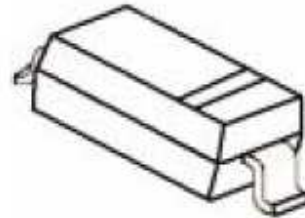

MARKING: T4

MECHANICAL DATA

- Flat Lead SOD-123 Small Outline Plastic Package
- Epoxy: UL94V-0 rate flame retardant
- Polarity: Color band denotes cathode end
- Mounting position: Any
- Weight: 0.0006 ounce, 0.017 gram

MAXIMUM RATINGS AND ELECTRICAL CHARACTERISTICS

- Ratings at 25°C ambient temperature unless otherwise specified
- Single Phase, half wave, 60Hz, resistive or inductive load
- For capacitive load derate current by 20%

Maximum Ratings & Thermal Characteristics (Ratings at 25°C ambient temperature unless otherwise specified.)

Parameters	Symbol	Value	Unit
Reverse Voltage	VR	75	V
Peak Reverse Voltage	VRM	100	V
Power Dissipation	Pd	500	mW
Operating junction temperature	Tj	150	°C
Storage temperature range	Ts	-65-150	°C
Working Inverse Voltage	WIV	75	V
Average Rectified Current	IO	150	mA
Non-repetitive Peak Forward Current	IFM	300	mA
Peak Forward Surge Current @tp=1us; TA=25°C	IFSM	2	A

Valid provided that electrodes are kept at ambient temperature.



WEE Technology Company Limited

High Speed Switching Diode

1N4148W

VOLTAGE RANGE 100 Volts

CURRENT 150m Ampere

Electrical Characteristics (Ratings at 25°C ambient temperature unless otherwise specified).

Symbols	Parameter	Test Condition	Limits		Unit
			Min	Max	
BV	Breakdown Voltage	IR=100uA IR=5uA	100 75		V
IR	Reverse Leakage Current	VR=20V VR=75	---	25 5	nA uA
VF	Forward Voltage	IF=10mA IF=100mA	---	1 1	V
TRR	Reverse Recovery Time	IF= 10mA, IR=60mA RL=100Ω IRR=1mA	---	4	nS
C	Capacitance	VR=0V, f=1MHZ	---	4	pF



WEET Technology Company Limited

High Speed Switching Diode

1N4148W

VOLTAGE RANGE 100 Volts
CURRENT 150m Ampere

Forward characteristics

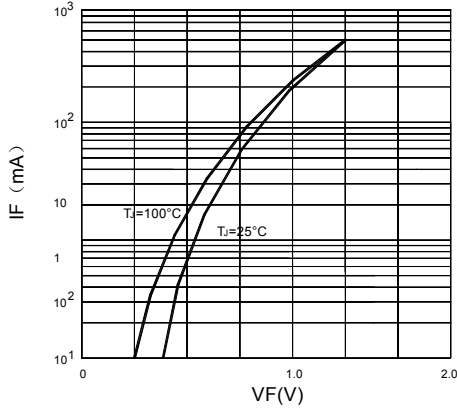

Admissible power dissipation versus ambient temperature

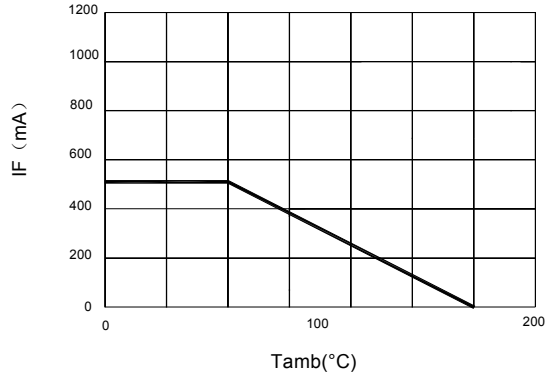

Leakage current versus junction temperature

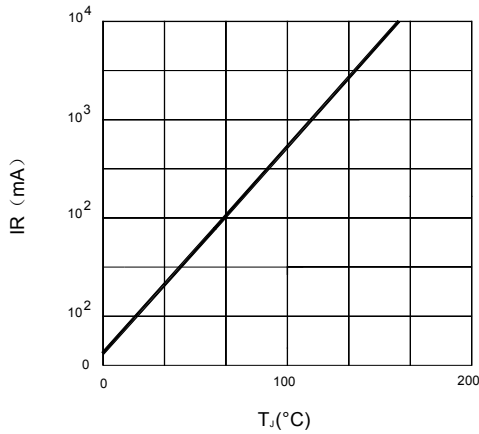

Reverse capacitance VS. reverse voltage

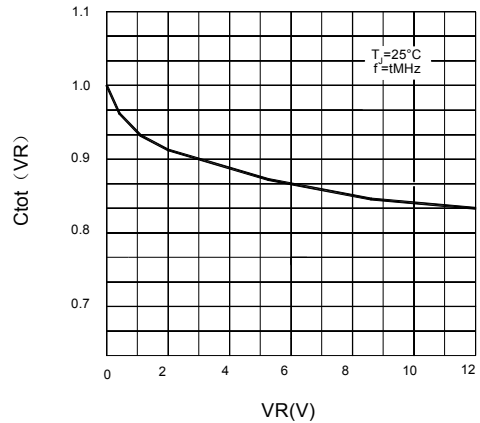

Admissible repetitive peak forward current VS. pulse duration

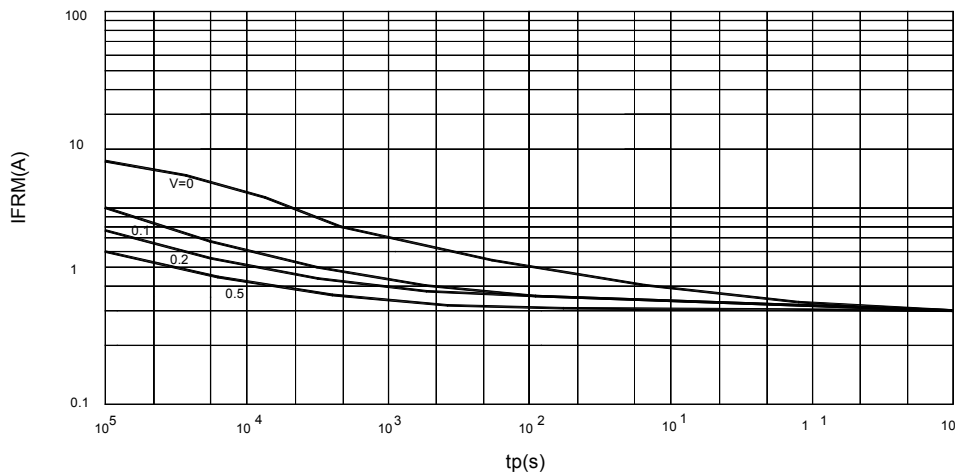



WEET Technology Company Limited

High Speed Switching Diode

1N4148W

VOLTAGE RANGE 100 Volts
 CURRENT 150m Ampere

SOD-123 PACKAGE OUTLINE

Plastic surface mounted package

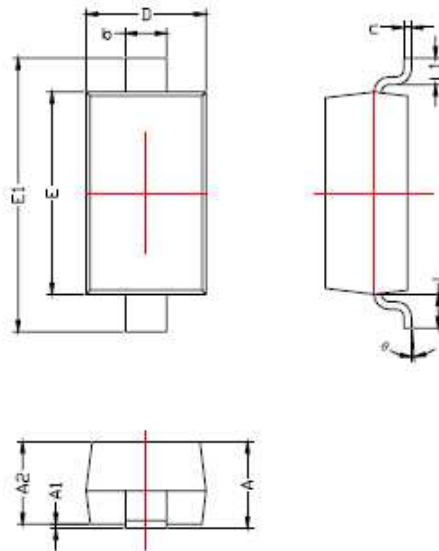

SYMBOL	DIMENSIONS	
	MIN.	MAX.
A	1.050	1.250
A1	0.000	0.100
A2	1.050	1.150
b	0.450	0.650
c	0.080	0.150
D	1.500	1.700
E	2.600	2.800
E1	3.550	3.850
L	0.500REF	
L1	0.250	0.450
θ	0°	8°

焊盘设计参考

Precautions: PCB Design

Recommended land dimensions for SOD-123 diode. Electrode patterns for PCBs

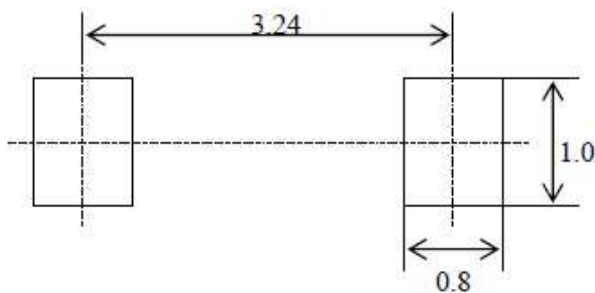

中心距: 3.24
 脚 宽: 0.55
 焊盘宽: 1.00
 脚 长: 0.50
 焊盘长: 0.80

技术要求:

- 1, 塑封体尺寸: 2.70 X 1.60
- 2, 未注公差为: ±0.05
- 3, 所有单位: mm

Note: Specifications are subject to change without notice. For more detail and update, please visit our website.